

Basic tools



Tape measure



Screwdrivers



Adjustable wrenches



Hacksaw & handsaw.



Teflon tape



Glove

Advance tools



Basin spanners.



caulking gun



Vise grip pliers.



Claw ball-pen hammers.



Hammer.



Sink tap spanner.



Product is fragile. To avoid breakage and possible injury handle with care. Picture may not exactly define.

STEP:1 STEAM GENERATOR SETUP

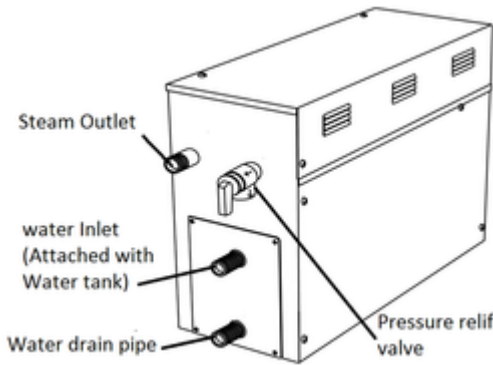

The steam generator should not be installed in the steam room. Install in a dry place where the ventilation is good.

Both sides and the top of the steam generator need to reserve at least 12 inches space.

The installation area must be convenient for the steam generator draining system.

STEP:2 PLUMBING INSTALLATION

The drawing is only for explanation purposes.

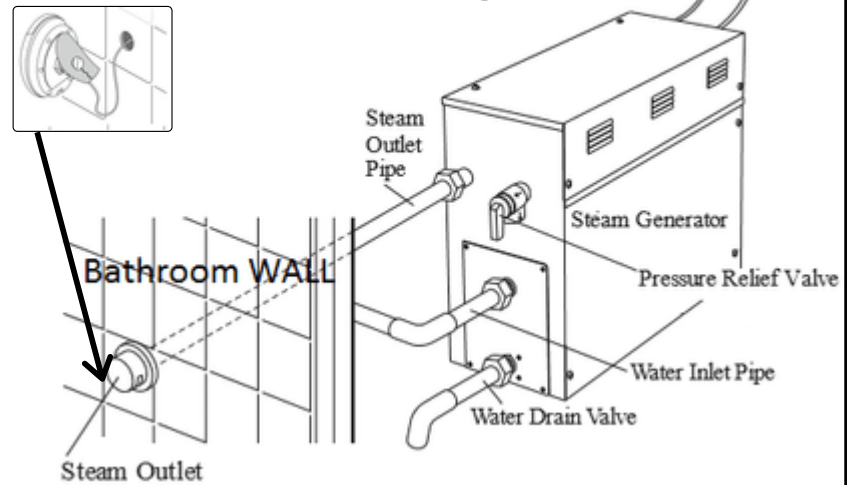

1. Use unions when connecting pipes.
2. Use brass pipes or copper hoses only.
3. Do not use black/galvanized/PVC pipes.

STEP:3 INSTALLATION OF STEAM OUTLET

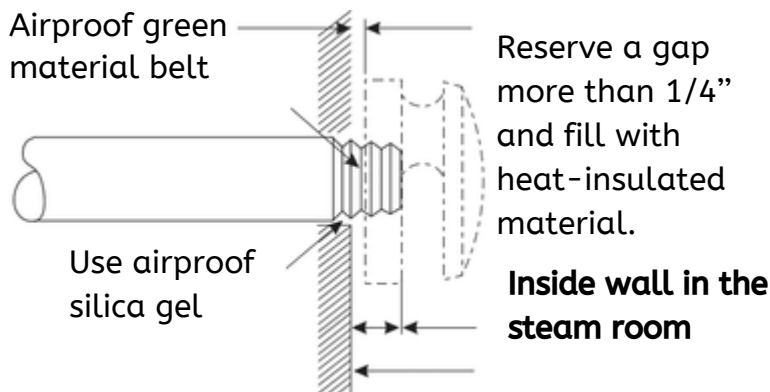

Reserve a gap more than 1/4" and fill with heat-insulated material.

Inside wall in the steam room

The pipes, its accessories and the holes should be air proof by applying glue so that no steam will enter the holes in the wall.

STEP:4 POWER ASSEMBLY

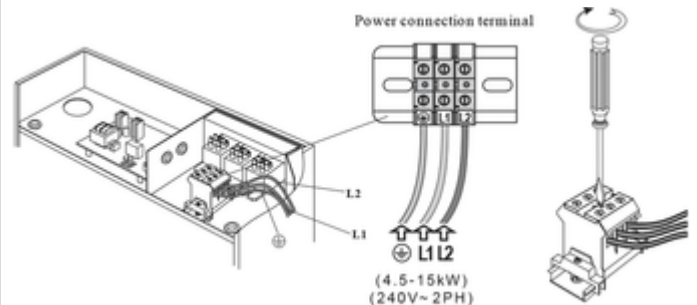

Do not connect electric current directly to heating elements

This graph is for explanation only. For actual installation, refer to national and local electricity consumption codes by professional electricians



Product is fragile. To avoid breakage and possible injury handle with care. Picture may not exactly define.

STEP:5 STEAM GENERATOR INTERNAL SETUP

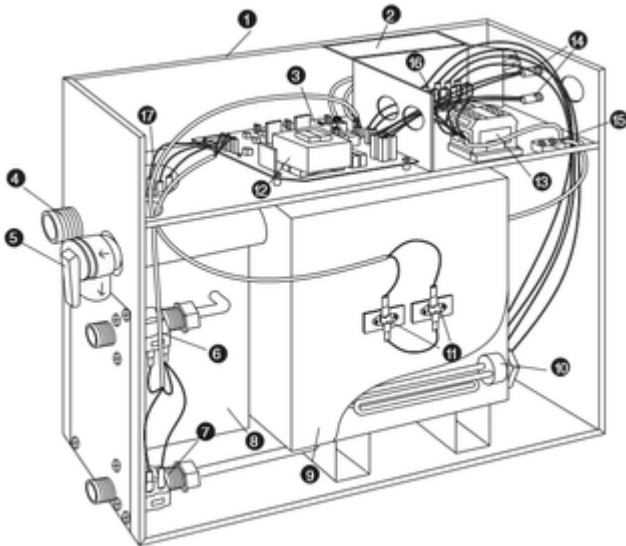

1. ENCLOSURE
2. INSULATION BRACKET
3. CIRCUIT BOARD
4. STEAM OUTLET
5. PRESSURE RELIEF VALVE
6. WATER FILL VALVE
7. WATER DRAIN VALVE
8. SUBSIDIARY WATER TANK
9. MAIN WATER TANK
10. HEATING ELEMENT
11. 221 F HI-LIMIT
12. TRANSFORMER
13. TERMINAL BLOCK
14. FUSE
15. GROUND WIRE CONNECTOR
16. RELAY
17. WATER LEVEL SENSOR

STEP:6 PANEL INSTALLATION ON WALL

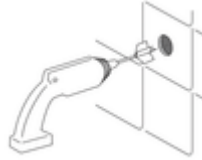

1. 4-5 feet from the ground.
2. Away from the steam head and do not expose under the direct spray of steam.
3. Install in the perpendicular wall.
4. The position of installation should facilitate easy operation and convenient wiring

STEP:7 ULTIMATE ASSEMBLY



SUPPORT

JAAZ CORPORATION PVT. LTD.
406 Onyx, Akshar Cross Road,
O. P. Road, Vadodara - 390 020.
Gujarat. INDIA

Write to us at:

+91 9408630765 support@jaaz.in
+91 2652280178 www.jaaz.in



Product is fragile. To avoid breakage and possible injury handle with care. Picture may not exactly define.

SAFETY AND USER MANUAL

1. The steam head is hot. DO NOT touch the steam head and avoid the steam near the steam head.
2. Excessive temperatures have a high potential for causing fetal damage during the early months of pregnancy. Pregnancy or possibly pregnant women should consult a physician regarding correct exposure.
3. Obese persons and persons with a history of heart disease, low or high blood pressure, circulatory system problems, or diabetes should consult a physician before using a steam bath.
4. Prolonged use of the steam system can raise excessively the internal human body temperature and impair the body's ability to regulate its internal temperature (hypothermia). Limit your use of steam to 10-15 minutes until you are certain of your body's reaction.
5. Use only mild soap and water on a soft cloth to clean the control and steam head. DO NOT use abrasive cleansers.
6. Persons using medication should consult a physician before using a steam bath since some medication may induce drowsiness while other medications may affect heart rate, blood pressure and circulation.

- **How it works:** Cold water piped into a steam generator is heated to the boiling point and then sends fresh steam to an aperture in the shower stall. Digital controls inside the shower let the user adjust the steam's temperature and duration and can even add piped-in aromas, lighting, and music.

SUPPORT

JAAZ CORPORATION PVT. LTD.
406 Onyx, Akshar Cross Road,
O. P. Road, Vadodara - 390 020.
Gujarat. INDIA

+91 9408630765
+91 2652280178

Write to us at:
support@jaaz.in
www.jaaz.in

Steam Generator specification

Sr No.	Model	KW (Power unit)	* Max Applicable space for the room (cu.ft)	Electric Current (A)	Power Wire (AWG)	Voltage (V)	Tempera ture Range (°C)	Time set Range (min) (CH for continue on)	Power Supply	Steam Generator Unit Dimension			Water Tanks Capacity (Liters)	Required plumbing Pipe size (in)		
										Length	Width	Height		Water Supply	Steam Outlet (GI/ Copper)	Drain
1	SG-3	3	75	19	12	240	35-60	1-60	Single Phase	42.5 cm	13.5 cm	28.5 cm	3.6 L	½	½	¾
2	SG-5	5	120	25	10	240	35-60	1-60	Single Phase	42.5 cm	13.5 cm	28.5 cm	3.6 L	½	½	¾
3	SG-7.5	7.5	225	32	8	240	35-60	1-60	3 Phase	48.5 cm	15.0 cm	31.0 cm	3.6 L	½	¾	¾
4	SG-9	9	300	38	8	240	35-60	1-60	3 Phase	48.5 cm	15.0 cm	31.0 cm	5.25 L	½	¾	¾
5	SG-12	12	450	50	6	240	35-60	1-60	3 Phase	48.5 cm	18.0 cm	34.5 cm	9.9 L	½	¾	¾

* Mentioned room space in the chart is for indicative purpose only, it may differ as per material used in the cube i.e. Tile, Glass or stone etc.